



Healthy Homes That Change Lives

## THE PRIMROSE 1,502 sq ft FRENCH COUNTRY

Newport Builders, Inc

8338 Corporate Dr. Suite 300 - Racine WI, 53406  
Office: 262.632.7373 fax: 262.632.8430

[www.newport-builders.com](http://www.newport-builders.com)



### Plan Highlights

- Traditional exterior with stone accent
- Granite countertops throughout
- Open concept plan
- Dura Ceramic floors in bathrooms

### Standard Features

- Vinyl windows w / low e
- Designer kitchen cabinet layout
- Kohler plumbing fixtures
- Stainless Steel kitchen appliances
- 95% Ultra-Efficient furnace & central air
- Fireplace with stone facing & wood mantle
- Brushed nickel lever and faucets
- Hardwood in kitchen and dining areas
- Focus on Energy saves 25% on utilities

Width: 64'  
Depth: 71'

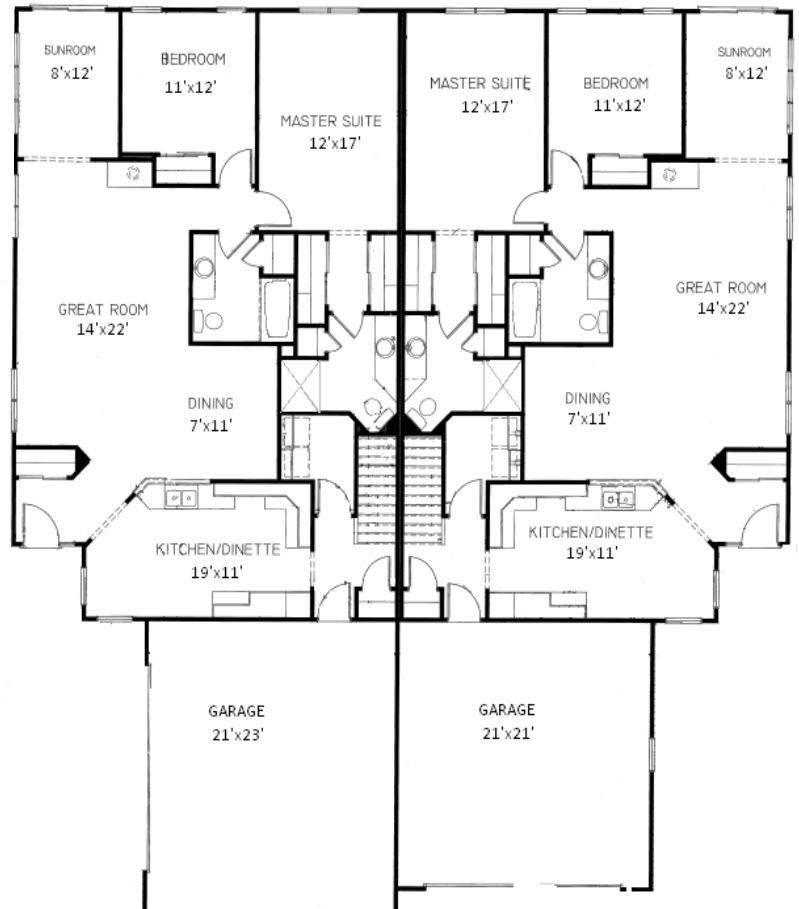

\*\*Features and specifications subject to change without notice. Pricing does not include homesite, site improvements or landscaping, subject to change without notice.